



**FRONT RUNNER**

**LAND ROVER DISCOVERY 3/4  
REAR MOUNT LADDER**

**ENG**

LALD004



**INSTALL TIME: 30 mins**

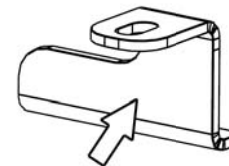
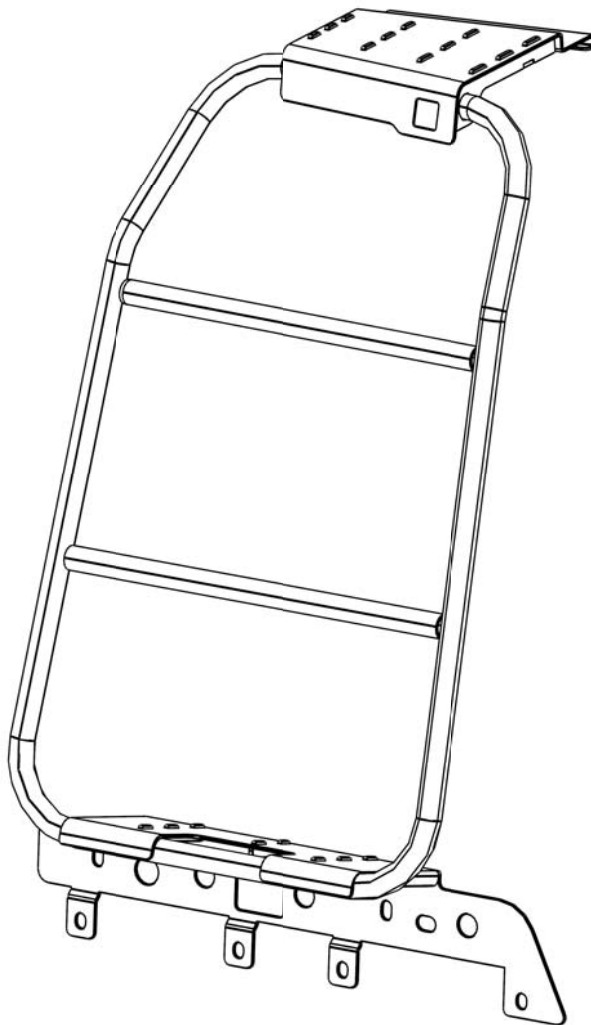

Z-Bracket - Step 2D

**IMPORTANT WARNING!**

IT IS CRITICAL THAT ALL FRONT RUNNER PRODUCTS BE PROPERLY AND SECURELY ASSEMBLED AND ATTACHED TO YOUR VEHICLE. IMPROPER ATTACHMENT COULD RESULT IN AN AUTOMOBILE ACCIDENT, AND COULD CAUSE SERIOUS BODILY INJURY OR DEATH TO YOU OR TO OTHERS. YOU ARE RESPONSIBLE FOR ASSEMBLING AND SECURING ALL FRONT RUNNER PRODUCTS TO YOUR VEHICLE, CHECKING THE ATTACHMENTS PRIOR TO USE, AND PERIODICALLY INSPECTING THE PRODUCTS FOR ADJUSTMENT, WEAR, AND DAMAGE. THEREFORE, YOU MUST READ AND UNDERSTAND ALL OF THE INSTRUCTIONS AND CAUTIONS SUPPLIED WITH YOUR FRONT RUNNER PRODUCT PRIOR TO INSTALLATION OR USE. IF YOU DO NOT UNDERSTAND ALL OF THE INSTRUCTIONS AND CAUTIONS, OR IF YOU HAVE NO MECHANICAL EXPERIENCE AND ARE NOT THOROUGHLY FAMILIAR WITH THE INSTALLATION PROCEDURES, YOU SHOULD HAVE THE PRODUCT INSTALLED BY A PROFESSIONAL INSTALLER OR OTHER QUALIFIED PERSONNEL.

# 1 PREP FOR LADDER FITMENT

You will need :

- ☐ 13 mm Flat Wrench
- ☐ 10 mm Socket Wrench
- ☐ T30 Torx Wrench
- ☐ Star Point / Phillips Screwdriver

( A ) Open the Top Rear Door and remove the four Torx Bolts as indicated by the arrows. You will need to lift the Rubber Door Seal in order to remove the far left Torx Bolt.

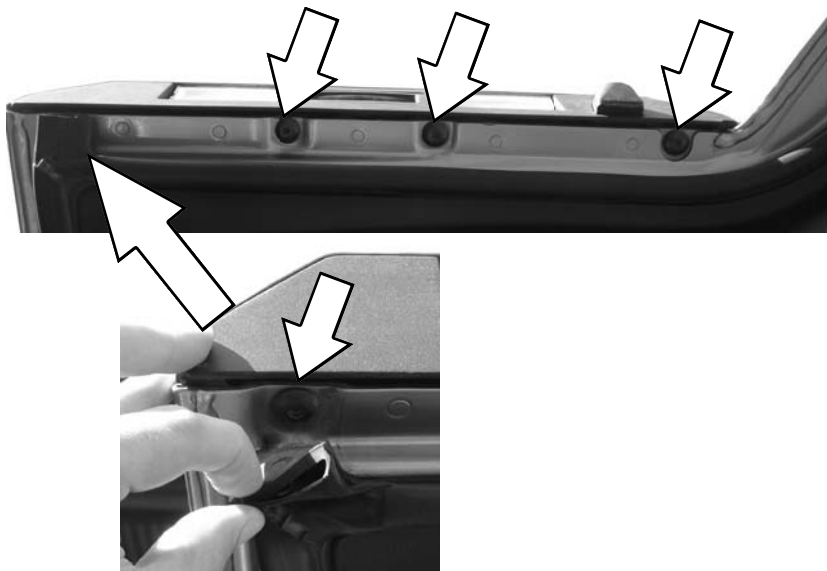

( B ) Remove the Screw inside the door handle.



( C ) Remove the Trim around the Door Striker.



( D ) Remove the Interior Trim Panel by pulling it away from the vehicle's body. Take care not to damage any of the Plastic Retaining Clips.



( E ) Disconnect the Electrical Connector as indicated (Including rear camera if fitted).

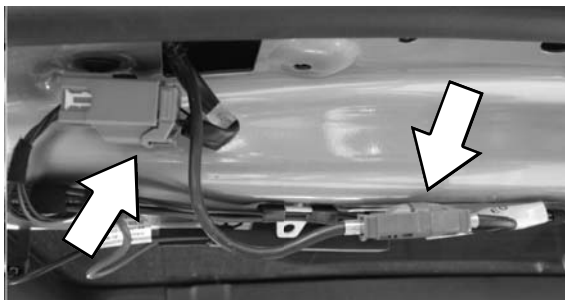

( F ) Undo the three Hex Nuts shown below.



## 1 PREP FOR LADDER FITMENT CONT...

- ( G ) Remove the Rear Number Plate Light Cluster from the vehicle. Open the Bottom Rear Door and close the Top Rear Door, so as to not accidentally lock the Rear Door.



## 2 FIT THE LADDER

- ( A ) Hook the lip at the top of the Ladder over the Top Edge of the Rear Door through the gap between the door and the vehicle's roof as shown. Push the Top Lip against the top edge of the Rear Door.

Push against Top  
Edge of Rear Door

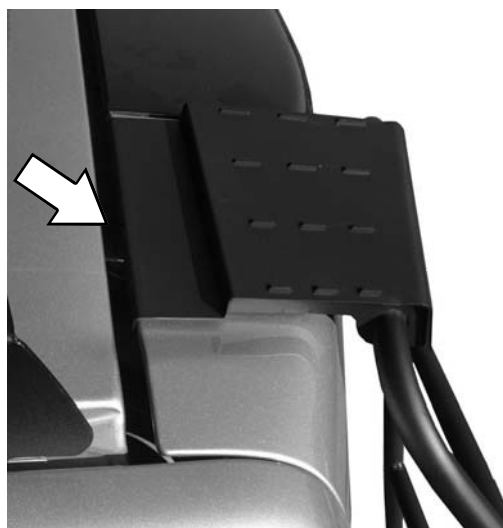
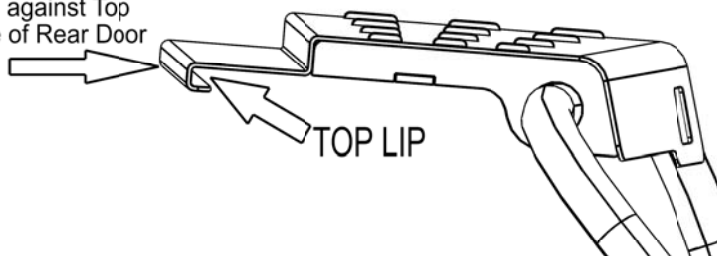

- ( B ) Align the holes in the bottom of the Ladder with the holes in the vehicle's body (behind the Rear Number Plate Light Cluster removed earlier).

Place the Rear Number Plate Light Cluster over the bottom of the Ladder and secure using the Hex Nuts removed in Step 1F.

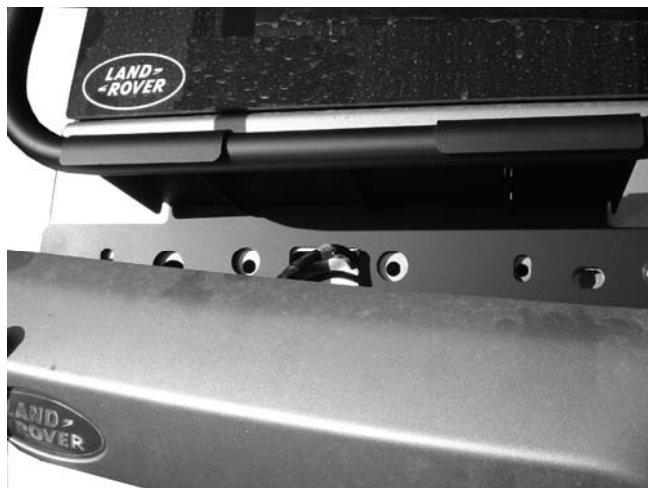

## 2 FIT LADDER CONT...

- ( C ) Open the Top rear Door and remove the outer Hex Bolt on the rear left hand side Door Hinge.

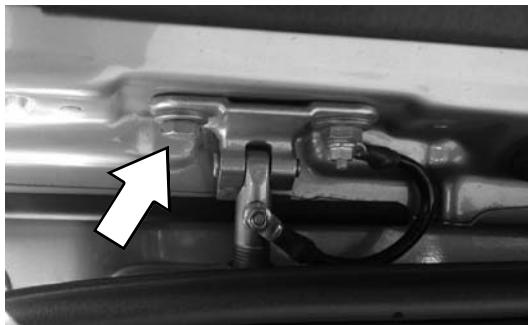

- ( D ) Ensure the Top Lip from the Ladder is against the Top Edge of the Rear Door (Refer to Step 2A). Place the "Z-Clamp" supplied over the Top Lip, lining up the hole in the "Z-clamp" with the bolt hole from Step 2C. Secure the "Z-clamp" to the vehicle using the Hex Bolt removed in Step 2C.



- ( E ) Reconnect the Electrical Plugs (Step 1E), refit the Trim (Steps 1B, 1C, 1D) and fasten the Torx Bolts removed in Step 1A.



Congratulations, you have completed your installation.  
Take a step back and admire your work. Good Job!

## 3 INSTALL OTHER VEHICLE AND RACK ACCESSORIES

- ( A ) Now's the time to visit your favorite Front Runner dealer in person or online.